

**PROPOSED PAVING FOR  
CENTRAL LANDSCAPE AREA**

**PORCH  
ENTRANCE**

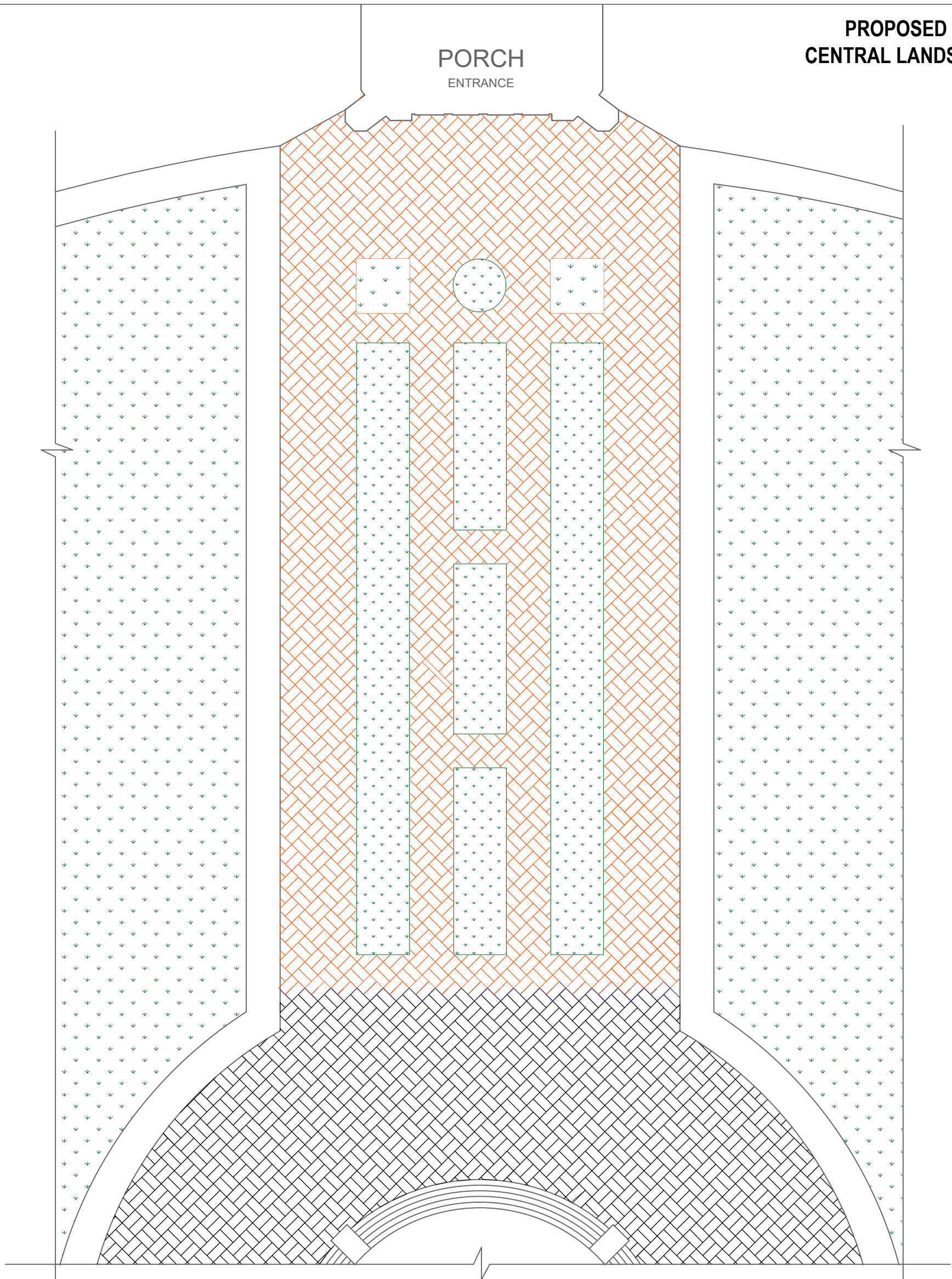

**LEGEND**

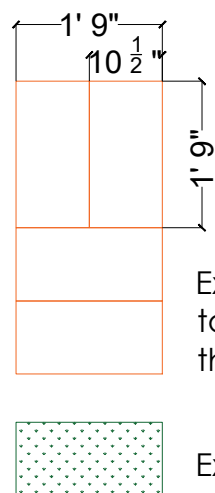

Existing paver block surface to be redone with 30-35 mm thick kaddapa stone

Existing lawn to be retained

**TYPICAL DETAIL 'B'**

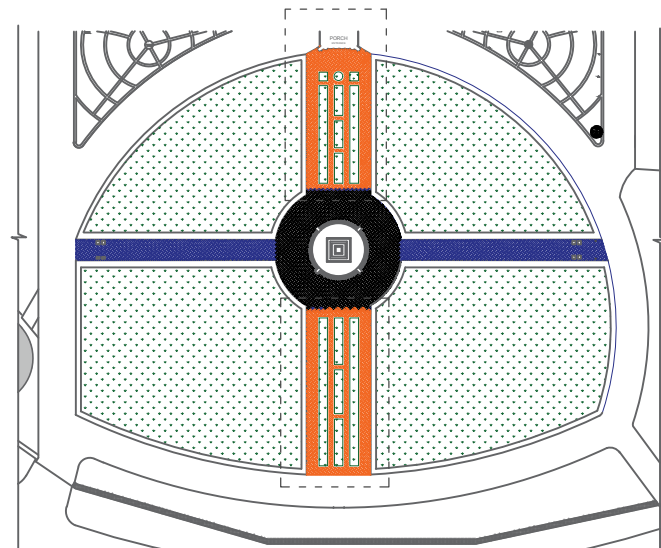

 **KEY PLAN**